



Kingsland, Harlow, CM18 6XR

Geoffrey Matthew Estates are pleased to offer this CHAIN FREE, two bedroom apartment in the popular residential area of Kingsland. In need of a degree of modernisation throughout, the property is ideally located for access to Town Centre, Amenities and Transport Links. This would make an ideal first time buy or investment.

Contact us to arrange your viewing.

Offers In The Region Of £190,000

Kingsland, Harlow, CM18 6XR

 2

 1

 1

 E

- CHAIN FREE
 - Contact Us For Viewings
- Two Bedrooms
- Centrally Located

Hallway

Lease term - 125 years from 6 June 1983

Kitchen

7'2 x 7'9 (2.18m x 2.36m)

Ground Rent - £10 per annum

Service Charge - Approx. £100 per month

Lounge

10'6 x 16'9 (3.20m x 5.11m)

Internal Hallway

Bedroom

9'5 x 14' (2.87m x 4.27m)

Bedroom

9'9 x 11' (2.97m x 3.35m)

Bathroom

5'6 x 6' (1.68m x 1.83m)

Agents Notes

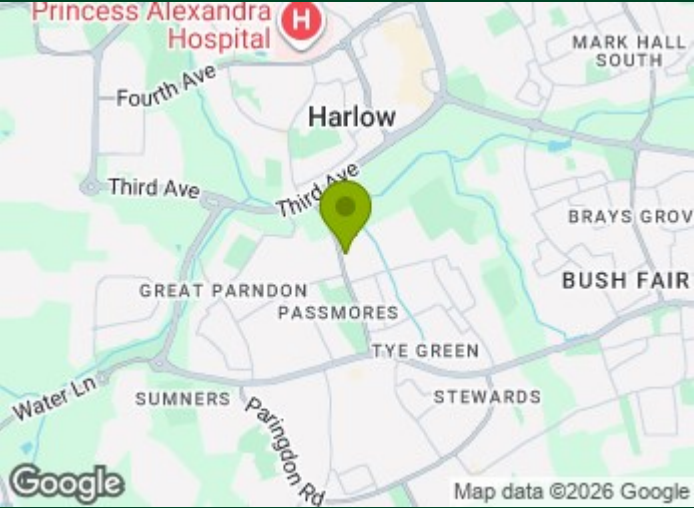

Directions



Floor Plan

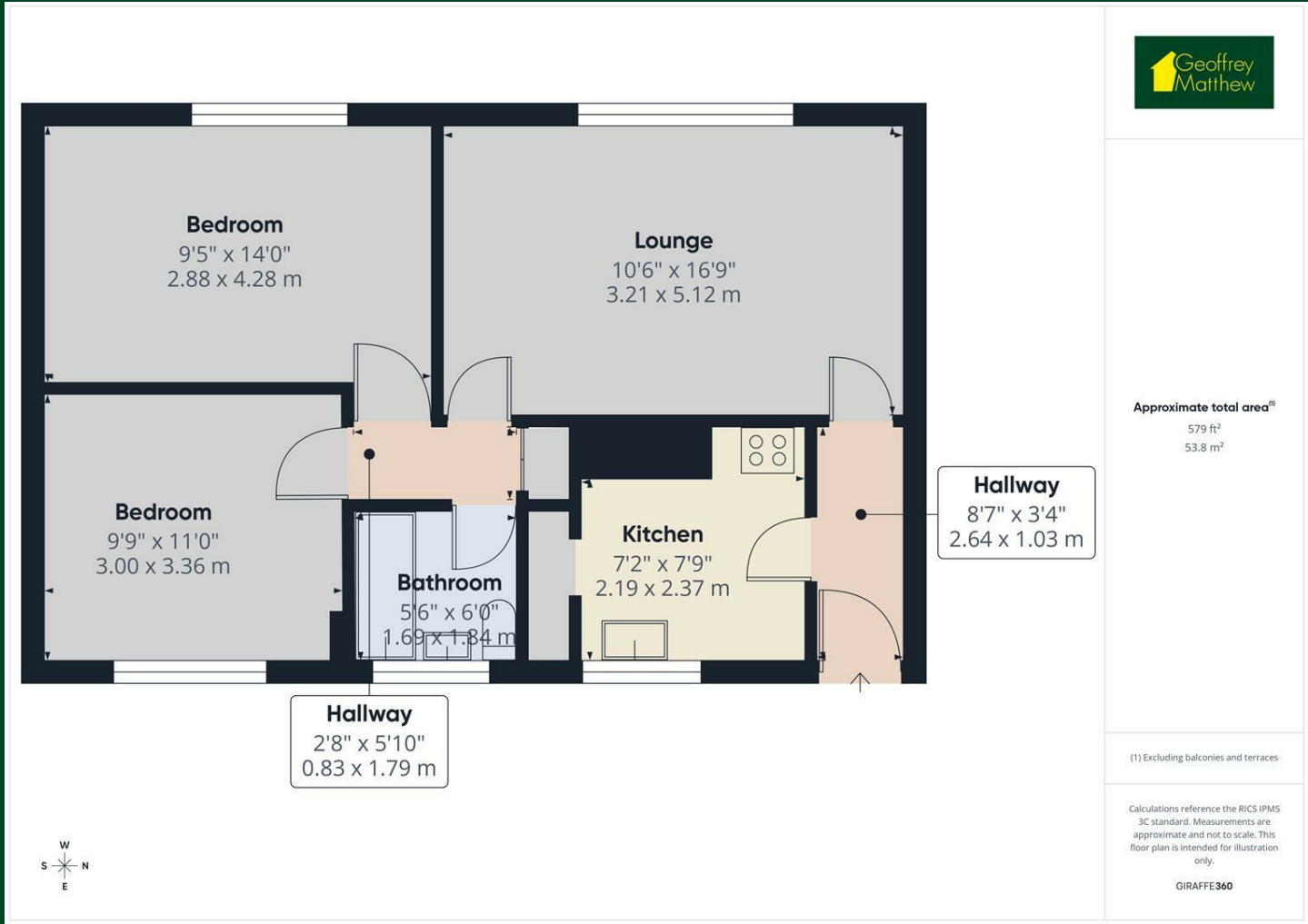

Council Tax Details

Harlow Band B

These particulars, whilst believed to be accurate are set out as a general outline only for guidance and do not constitute any part of an offer or contract. Intending purchasers should not rely on them as statements of representation of fact, but must satisfy themselves by inspection or otherwise as to their accuracy. No person in this firms employment has the authority to make or give any representation or warranty in respect of the property.

